

EGFA

N52 06.88 W004 33.57 **WEST WALES/Aberporth** 428ft AMSL

4 nm ENE of Cardigan. //absent.smoke.undivided **STU 113-10 069 19-2**

c/s Aberporth Radar 120-835 - SUACS EGD 201/202

c/s West Wales Information/Radio 122-155 AFIS/A/G and SUAAIS D201/D202

c/s West Wales Radar 127-090 - SUACS EGD 201/202 When notified by NOTAM

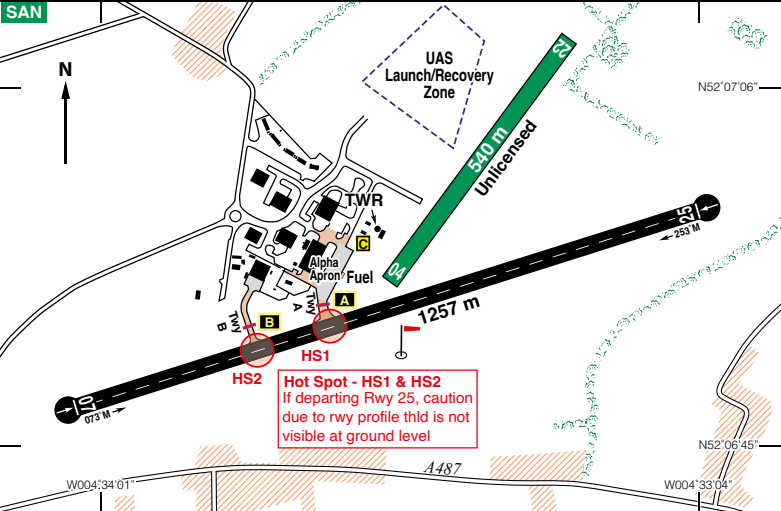

Rwy	Dim(m)	Surface	TORA(m)	LDA(m)	Lighting
07/25	1257x30	Asphalt	08-1199	08-1186	Nil
04/22	540x32	Grass	26-1199	26-1186	Nil
				Unlicensed	Nil

Op hrs: PPR by telephone. Mon-Fri except PH 0900-1630 or SS whichever is earlier.

Landing Fee: Advised when calling for PPR.

Customs: Nil. **Hangarage:** Limited. **Maintenance:** Nil.

Remarks: Operated by West Wales Airport Ltd., West Wales Airport, Blaenannerch, Aberporth, Ceredigion SA43 2DZ. Non-radio aircraft prohibited.

Part of the ATZ is within Danger Area D201H and D202D. For safe operation within the ATZ, unless otherwise notified by the AFIS/A/G, following procedures must be complied with:

When EGD 202D is notified 'Active' inbound aircraft are required to call Aberporth Radar on 120-835 or when notified West Wales Radar on 127-090, otherwise call West Wales Information on 122-155.

Unless otherwise notified by West Wales Information/Radio, a standard circuit joining procedure via overhead the AD is not permitted. The Southern lateral limit D201H is located approximately 1 nm North of the centreline of Rwy 07/25.

continued

Remarks (continued):

When notified active, entry in to the circuit is to ensure that acft avoid entry into the danger area. The intended entry point into the circuit should be notified to West Wales Information/Radio.

Unmanned Aerial Vehicle (UAV) flights take place at the aerodrome.

Circuits at 1000ft aal, LH on Rwy 22 and 25, RH on Rwy 04 and 07.

High visibility clothing when airside is strongly recommended.

Unmanned aircraft systems (including model aircraft) operates from the North East corner of the aerodrome, position N52 07 07.1 W004 33 27.9, up to 200ft AGL (676ft AMSL) and occasionally up to 400ft AGL (876ft AMSL), during daylight hours until 2000 (1900). Go-arounds on Rwy 07/25 are to be carried out on the live side only.

FRZ (EGR2U001A) active with Unmanned Aircraft Systems (including model aircraft), SFC-400ft AGL (867ft AMSL) outside of AD published hours.

Helicopter Operations: All wheel equipped helicopters are required to land and take-off on the runway and ground taxi to/from the apron.

Restaurants: Light refreshments available.

Fuel: 100LL, Jet A1.

Tel: 01239 811100

Email: wwaops@flyuav.co.uk

Website: www.flyuav.co.uk