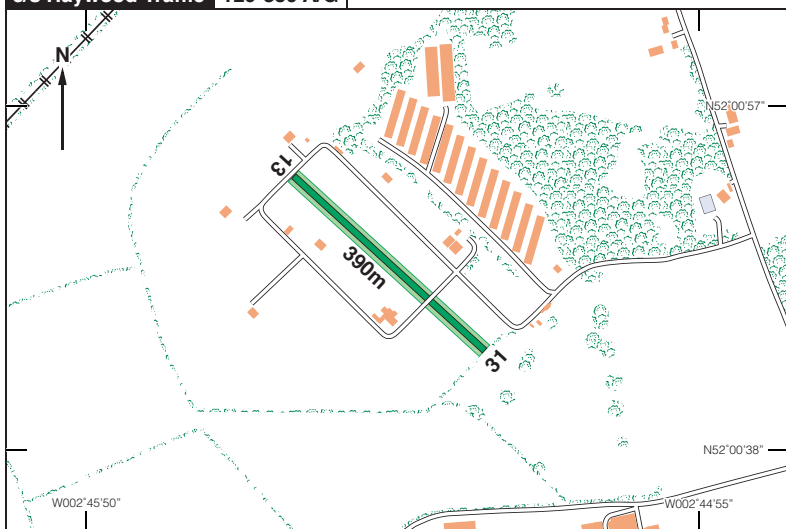

N52 00.80 W002 45.37

HAYWOOD FARM AIRFIELD

320ft AMSL

5.3 nm SSW of Hereford.

c/s Haywood Traffic 129-830 A/G

Rwy	Dim(m)	Surface	TORA(m)	LDA(m)	Lighting
13/31	390x30	Grass	Unlicensed		Nil

Op hrs: Sunrise - Sunset Strictly PPR.**Landing Fee:** Nil.**Hangarage:** Nil.**Maintenance:** Nil.**Customs:** Nil.**Remarks:** Leased to Haywood Flyers.

Unlicensed airfield, strictly PPR and be aware of the proximity of Broadmeadow Farm Airfield to the north.

Microlight and small light aircraft welcome at pilots own risk.

There is limited use of the tracks at both the NW end and across the SE end of the runway so keep a good lookout when landing and taking off.

The SE end track is closed off when local flying is taking place

Circuit height 700ft, Rwy 13 RH, Rwy 31 LH.

Please avoid areas as shown on chart overleaf.

Restaurant: Beverage making facilities are available.**Fuel:** MOGAS, By arrangement.**Mob:** 07768 131349 John Hunt**Mob:** 07887 564170 Spencer Harvey**Email:** huntwing@hotmail.co.uk**Email:** spencerdjharvey@gmail.com

HAYWOOD AIRFIELD Noise Abatement & Circuits

