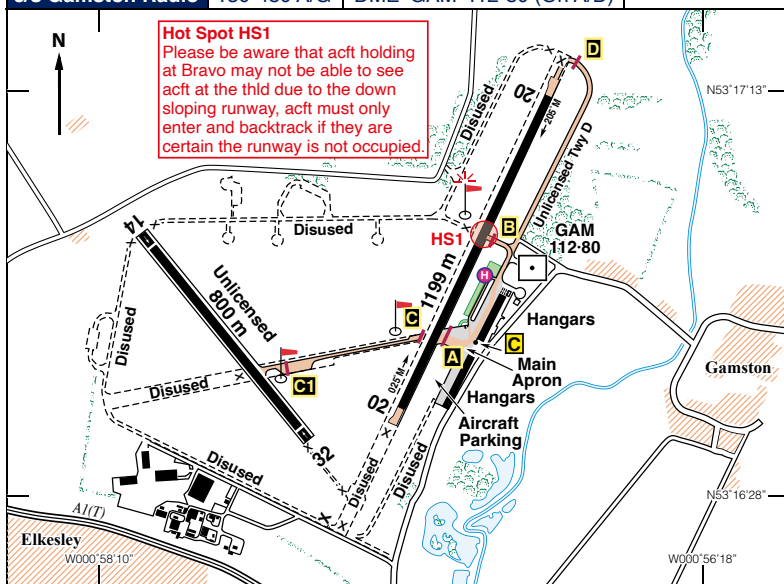

N53 16.83 W000 57.08 **RETTFORD/Gamston** 87ft AMSL

2 nm S of Retford. ///restored.dime.materials

OTR 113-90 234 39-2**c/s Gamston Radio** 130-480 A/G **DME 'GAM' 112-80 (On A/D)**

Rwy	Dim(m)	Surface	TORA(m)	LDA(m)	Lighting
02/20	1199x23	Asphalt	02-1199 20-1199	02-1199 20-1199	Thr Rwy PAPI 3.5° Thr Rwy PAPI 3.5°
14/32	800x18	Asphalt	unlicensed		Nil

Op hrs: PPR mandatory. Mon-Fri 0800-1800; Sat, Sun & PHs 0900-1800.
On request Mon-Fri 0600-0759, 1801-2300; Sat, Sun & PHs 0800-0859, 1801-2100.

Landing Fee: Up to 999 kg £15; 1000-1999 kg £18; 2000-2999 kg £25; 3000-3999 kg £35; 4000-4999kg £60; 5000-5999kg £120, then an additional £20 per tonne or part thereof upto 12999kg. Half Price Landing Fees up to 2999kg when £10 is spent in the café. Parking for visiting acft is located on the southern apron and park parking to the right of the tower. Confirm parking availability on arrival due to dual use capabilities of this apron.

Hangarage/Maintenance: Limited.

Customs: Nil.

Remarks: Operated by Gamston Aviation Ltd, Retford (Gamston) Airport, Ollerton Road, Retford, Notts DN22 0QL.

The airport is strictly PPR for all non-based aircraft. PPR can be completed online at <https://www.retfordairport.co.uk/> or by calling 01777 838521, option 1.

Aircraft must obtain confirmation that PPR has been accepted before departing for the AD. Airborne PPRs are not accepted unless in the event of an emergency. High visibility vests/jackets required on the Ramp, Apron and Hangar areas.

Remarks (continued):

Circuits at 1000ft QFE or 1100ft QNH; 02 Left hand; 20 Right hand; 14 (unlicensed) Right hand (fixed wing), Left hand (rotary); 32 (unlicensed) Left hand (fixed wing), Right hand (rotary). Pilots are recommended to join overhead. When joining for Rwy 14/32, fixed wing pilots should avoid descending below 1300ft QFE until south of the runway to maintain separation with the rotary circuit.

Pilots should avoid overflying Gamston Village, Elkesely, Eaton, West Drayton, and other residential areas in the vicinity of the ATZ.

When using runway 14, pilots should avoid departing straight ahead, instead, make an early right turn crosswind to avoid West Drayton.

When using Rwy 32, EFATO/fan stops are not permitted.

When using Rwy 32, pilots should avoid departing straight ahead, instead make an early left turn, if safe to do so, to avoid noise sensitive area.

Detailed circuit diagrams and noise abatement information is available on the web-site. Check NOTAMS carefully for details of dual operations activities.

A telephone briefing is available on Tel: 01777 838521, option 1.

Handling Agent: Contact Gamston Aviation, Tel: 01777 838521.

Access to and from Rwy 02/20 is via points A and B only. Access to Rwy 14/332 is via C1 only. Other paved taxiways are unusable.

All visiting turboprop and jet acft are advised to contact Gamston Aviation Ltd prior to obtaining PPR and organise any necessary RFFS provision increase - Tel: 01777 838521.

Visual Reference Points (VRPs)**VRP****Co-ordinates**

Thorsby Lake N53 13.63 W001 03.33

Daneshill Lakes N53 21.62 W000 56.12

Gainsborough N53 23.57 W000 46.25

A1/A57 Clumber Interchange N53 17.78 W001 01.93

Restaurant: The Apron Café, 0900-1730 Wed-Fri, 0900-1730 Sat-Sun.
Tel: 01777 838521 Ext 2 for availability. Pre-booking is advised.

Fuel: 100LL, JetA1. Delivered directly and efficiently to your aircraft by our bowzers.

Tel: 01777 838521 Ext 1 (Ops)
Website: <https://www.retfordairport.co.uk>

RETFORD CIRCUITS FIXED WING & ROTARY

