

EGLP

N51 23-03 W001 10-02

BRIMPTON AIRFIELD

210 ft AMSL

5.5 nm ESE of Newbury

SAM 113-35 014 26.5. MID 114-00 314 28.5

CPT 114-35 164 6.7

c/s Brimpton Radio 135-130 A/G.

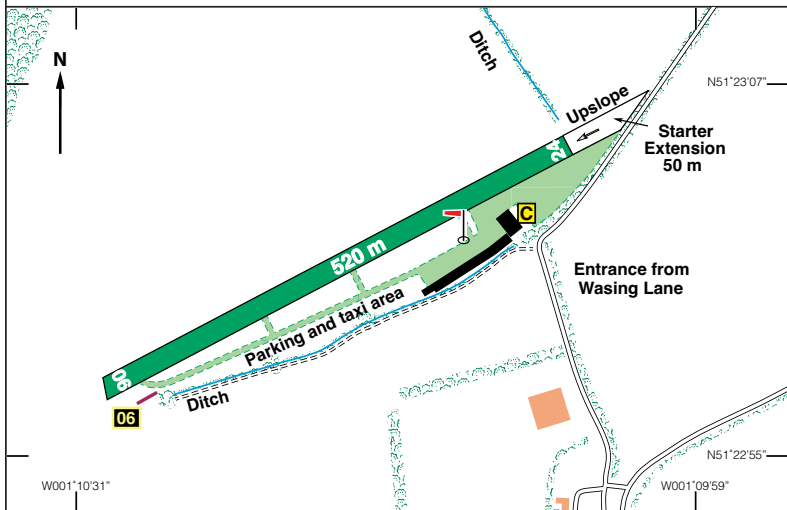

Rwy	Dim(m)	Surface	TORA(m)	LDA(m)	Lighting
06/24	520x25	Grass	Unlicensed	Nil	Nil
Additional 50 m available for take-off Rwy 24. (Upslope)					

Op hrs: Strictly PPR by telephone or via website, 0800-(SS-30 mins)

Landing Fee: Microlight £5, Glider Free; Glider Tug £7.50; Single £7.50; Twin £15; Helicopters £15. (All inc VAT) Acft over 2045kg contact operator. Overnight Parking £5.

Maintenance: Limited. **Hangarage:** Contact Operator. **Customs:** Nil.

Remarks: Operated by Robin Greatrex, Brimpton Airfield Ltd. Brimpton Airfield, Wasing Lane, Brimpton, Berkshire, RG7 4LY.

Warning: Airfield is situated in the NW edge of the Restricted Area - R101/2.4 and operates under special exemption requiring notification when the airfield is active. Model aircraft may be flying to the North of the runway.

PPR Mandatory. ALL pilots to obtain PPR via website (preferred) or telephone. Pilots welcome at their own risk.

Circuits: See circuit diagram overleaf.

Restaurant: See website for local restaurants. Hot & cold drinks available in the club house.

Taxis: Broadway Cars, www.broadway-cars.com Tel: 01635 847784.

Fuel: Nil

PPR via website preferred or **Tel:** 0118 3246888
Mob: 07882 471000 Airfield Mgr & Operator.
Tel: 0118 3246888 Club house & PPR.
Email: brimpton.radio@brimpton-airfield.co.uk
Website: www.brimpton-airfield.co.uk

BRIMPTON CIRCUIT DIAGRAM

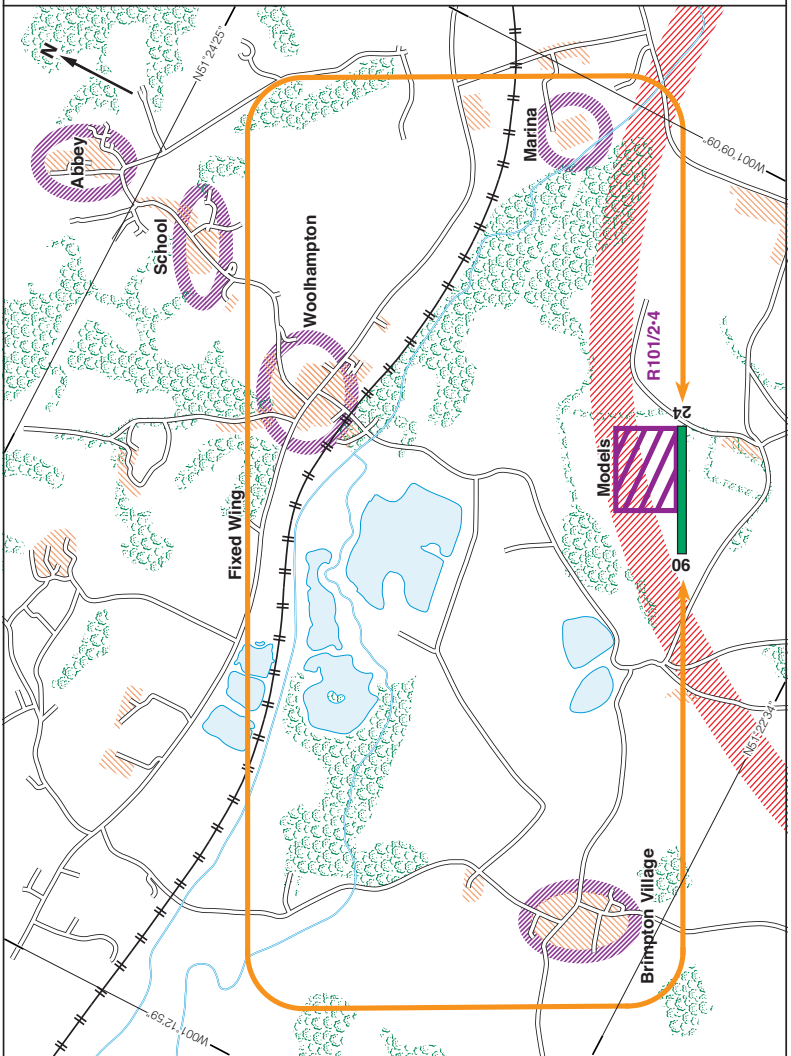

Changes: New circuit diagram.

Circuits: No overhead joins are permitted. All circuits to the North at 800 ft QFE, LH on Rwy 06, RH on Rwy 24. Join downwind and avoid overflying the villages of Brimpton; Aldermaston; Woolhampton and all local habitation close to the circuit.