

# EGBN (NQ7)

N52 55.20 W001 04.75 **NOTTINGHAM CITY HELIPORT** 138ft AMSL

3 nm SE of Nottingham. ///friday.thus.roofs

**c/s Nottingham Radio** 134•880 A/G | East Midlands RAD 134•180(LARS) H24

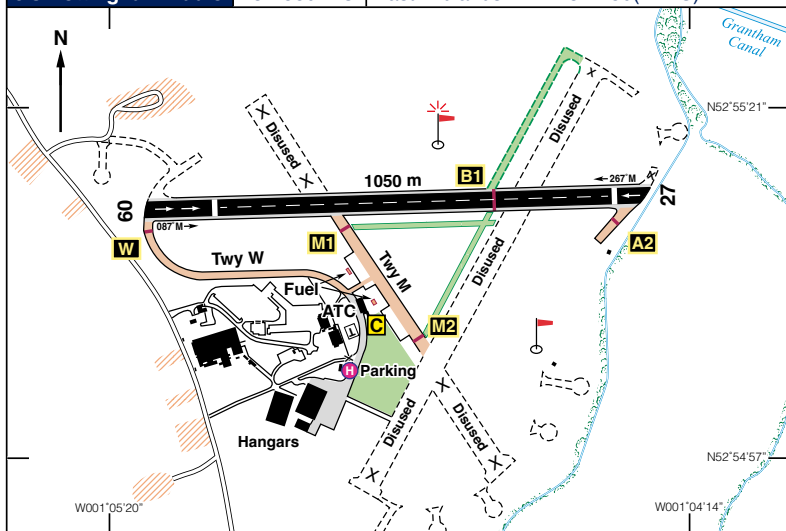

Rwy	Dim(m)	Surface	TORA(m)	LDA(m)	Lighting
09/27	1050x30	Asphalt/ Concrete	09-989 27-970	09-837 27-929	Thr Rwy APAPI 3.5° Thr Rwy APAPI 3.5°

**Op hrs:** Rotary operations by PPR preferred. AGCS not available Sun-Tue.  
Fire crew monitor frequency for emergency/fuel requests.  
Blind calls required when AGCS inactive.

**Landing Fee:** Via PPR.

**Customs:** O/R.

**Hangarage:** Available.

**Maintenance:** Available

**Remarks:** Heliport only, unavailable to fixed wing aircraft.

Operated by Truman Aviation Ltd., Nottingham City Airport, Tollerton, Notts, NG12 4GA. Non-radio aircraft strictly PPR.

Aerodrome situated on the Northern edge of East Midlands CTA (Class 'D'), contact East Midlands Radar 134•180 for CTA transit and traffic information.

This aerodrome operates solely as a heliport.

*continued*

**Remarks (continued):**

Helicopters to park on the grass at the south of the control tower.

Helicopter Circuit height 600ft QFE.

High visibility clothing required on manoeuvring area.

Helicopters are to park on the grass at the south of the Control Tower.

**Noise Abatement Procedures:** For noise abatement, pilots are requested to avoid overflying adjacent built-up areas and join overhead or dead-side only.

A 10 degree right turn is required after departing rwy 21 to avoid Tollerton Hall and surrounding buildings.

**Warnings:** Power cables outside the southern and eastern boundary of ATZ, max elevation 445ft amsl.

Power cables running NE/SW inside NE sector of ATZ, max elevation 328ft amsl.

Model flying club approx 1.9 nm NW of the aerodrome at Nottingham Racecourse.

Operating not above 400ft AGL.

Permanently based cranes are situated in Nottingham City with heights up to 400ft.

**Restaurant:** Facilities available all week.

**Fuel:** 100LL, Jet A1 available 7 days a week. OOH by request. Rotors running refuelling available. All major cards accepted except Amex & Diners.

**Tel:** 0115 9815050 Sales/ATC

**Email:** [info@trumanaviation.co.uk](mailto:info@trumanaviation.co.uk)

**Website:** [www.nottinghamairport.co.uk](http://www.nottinghamairport.co.uk)